





Big thanks to Simon who sent the following two-page guide after purchasing our ACCMB1 bracket. He wishes to share this with other customers. A real big help, we really appreciate all the help/info/images that is shared from our customers. We are more than happy to pass this on to help others.

<h1>How to Fit the ACCMB1 Bracket to a 2020 Mercedes Sprinter (may also fit other Sprinter models)</h1> <p>Written by Simon. Shared by: REVCAMUK Reversing cameras UK Ltd</p>		<h2>ACCMB1</h2>  <p>Fits Rarer Mercedes Button:</p> <p>Rare Mercedes bracket to fit to MON293B rear view mirror monitor</p> <p>MON293B Brackets</p>
<p>1. Remove the plastic panel that covers the electronics at the top of the windscreen – it pulls out easily. That will reveal the mounting plate:</p>		
<p>2. Turn the bracket so it is at the “10 o’clock” position, push firmly, and twist so it clicks into place at the “12 o’clock” position. Once it is in place it is held firmly:</p>		
<p>3. Remove the rectangular plastic plate from the middle of the plastic cover. It has press clips at the top and tabs on the bottom:</p>		

4. Make a cardboard template with a hole to accommodate the bracket, then cut the hole in the plastic plate (using a drill to get radiused corners). The dimensions are as shown:

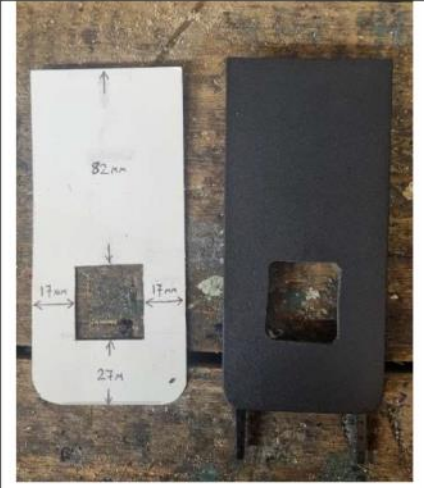

5. Put the plastic plate over the bracket, clip it back in to the plastic panel, then click the plastic panel back into place:



6. The final job looks like this. (Note that the mirror / screen plate does swivel but it is quite stiff and it may be easier to adjust it to the right angle before the bracket is mounted. Penetrating oil helps):

